

TERMINAL END VIEW

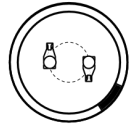

PCB LAYOUT

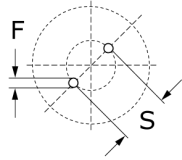

Click [here](#) for the 3D model.

#### Dimensions

D	35mm +/-1mm
L	40mm +/-2mm
S	10mm +/-0.1mm
LL	6.3mm +/-1mm
F	2mm +/-0.1mm

#### Packaging Specifications

Packaging	Tray
-----------	------

#### General Information

Series	ALH82
Dielectric	Aluminum Electrolytic
Style	Snap-In
Description	Snap-In, Aluminum Electrolytic
RoHS	Yes
AEC-Q200	No
Halogen Free	true
Typical Component Weight	65 g
Shelf Life	156 Weeks

#### Specifications

Capacitance	180 uF
Capacitance Tolerance	20%
Voltage DC	550 VDC
Temperature Range	-40/+105°C
Rated Temperature	105°C
Life	3000 Hrs (Rated Voltage And Ripple Current At 105C)
ESR	727 mOhms (100Hz 20C), 500 mOhms (10kHz 20C)
Ripple Current	1.86 Amps (100Hz 105C), 4.85 Amps (10Hz 105C)
Leakage Current	297 uA (5min 20°C)