

TOP VIEW  
Single or Double Chip Stack

PROFILE VIEW  
Single Chip Stack

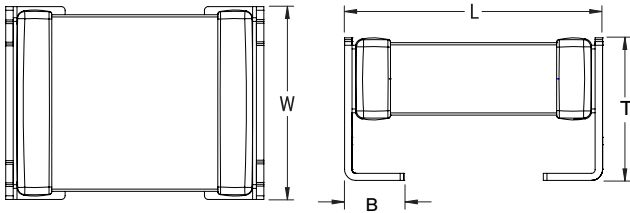

Click [here](#) for the 3D model.

**General Information**

Series	KPS SMD Auto X7R HV
Style	Stacked Chip
Description	SMD, MLCC, Stacked, Single Chip, High Voltage, Class II, Automotive Grade
Features	Automotive Grade
RoHS	Yes
Termination	Tin
Qualifications	AEC-Q200
AEC-Q200	Yes
Typical Component Weight	410 mg
Miscellaneous	X7R dielectric is not recommended for AC line filtering or pulse applications.
Chip Size	2220-1
Shelf Life	78 Weeks
MSL	1

**Dimensions**

L	6mm +/-0.5mm
W	5mm +/-0.5mm
T	3.5mm +/-0.30mm
B	1.6mm +/-0.3mm

**Packaging Specifications**

Packaging	T&R, 180mm, Plastic Tape
Packaging Quantity	300

**Specifications**

Capacitance	0.22 uF
Measurement Condition	1 kHz 1.0Vrms
Capacitance Tolerance	10%
Voltage DC	500 VDC
Dielectric Withstanding Voltage	750 VDC
Temperature Range	-55/+125°C
Temperature Coefficient	X7R
Capacitance Change with Reference to +25°C and 0 VDC Applied (TCC)	15%, 1kHz 1.0Vrms
Dissipation Factor	2.5% 1 kHz 1.0Vrms
Aging Rate	3% Loss/Decade Hour: Referee Time is 1000 Hours
Insulation Resistance	4.5455 GOhms

Statements of suitability for certain applications are based on our knowledge of typical operating conditions for such applications, but are not intended to constitute - and we specifically disclaim - any warranty concerning suitability for a specific customer application or use. This Information is intended for use only by customers who have the requisite experience and capability to determine the correct products for their application. Any technical advice inferred from this Information or otherwise provided by us with reference to the use of our products is given gratis, and we assume no obligation or liability for the advice given or results obtained.