

C316C222K1R5TA7303

Aliases (C316C222K1R5TATR)

GoldMax 300 Comm X7R, Ceramic, 2,200 pF, 10%, 100 VDC, X7R,
GoldMax, Commercial Standard, 2.54 mm

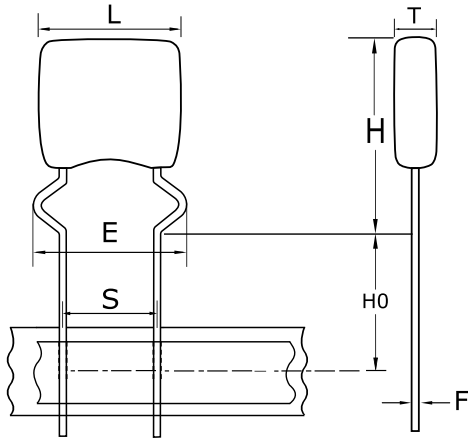

Click [here](#) for the 3D model.

General Information

| | |
|--------------|------------------------------|
| Series | GoldMax 300 Comm X7R |
| Style | Radial |
| Description | GoldMax, Commercial Standard |
| RoHS | Yes |
| Termination | Tin |
| Lead | Crimped Out |
| Failure Rate | N/A |
| AEC-Q200 | No |
| Halogen Free | Yes |

Dimensions

| | |
|----|----------------------|
| L | 3.81mm MAX |
| H | 5.84mm MAX |
| T | 2.54mm MAX |
| S | 2.54mm +/-0.78mm |
| H0 | 18mm MIN |
| F | 0.51mm +0.1/-0.025mm |
| E | 5.08mm NOM |

Packaging Specifications

| | |
|--------------------|------------|
| Packaging | T&R, 305mm |
| Packaging Quantity | 2500 |

Specifications

| | |
|--|---------------------|
| Capacitance | 2,200 pF |
| Measurement Condition | 1 kHz 1.0Vrms |
| Tolerance | 10% |
| Voltage DC | 100 VDC |
| Dielectric Withstanding Voltage | 250 VDC |
| Temperature Range | -55/+125°C |
| Temp. Coefficient | X7R |
| Capacitance Change with Reference to +25°C and 0 VDC Applied (TCC) | 0.15, 1kHz 1.0Vrms |
| Dissipation Factor | 2.5% 1 kHz 1.0Vrms |
| Aging Rate | 3% Loss/Decade Hour |
| Insulation Resistance | 100 GOhms |

Statements of suitability for certain applications are based on our knowledge of typical operating conditions for such applications, but are not intended to constitute - and we specifically disclaim - any warranty concerning suitability for a specific customer application or use. This Information is intended for use only by customers who have the requisite experience and capability to determine the correct products for their application. Any technical advice inferred from this Information or otherwise provided by us with reference to the use of our products is given gratis, and we assume no obligation or liability for the advice given or results obtained.