

SIDE VIEW

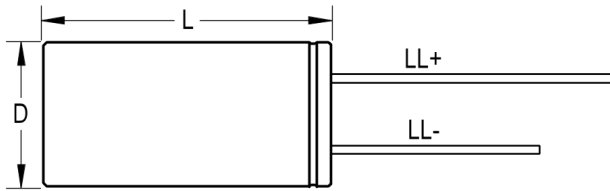

TERMINAL END VIEW

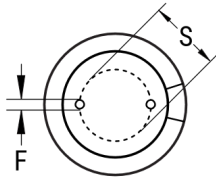

Click [here](#) for the 3D model.

### Dimensions

D	5mm +/-0.5mm
L	11mm +1.5mm
S	2mm +/-0.5mm
LL Negative	15mm MIN
LL Positive	20mm MIN
F	0.5mm NOM

### Packaging Specifications

Packaging	Bulk, Bag
-----------	-----------

### General Information

Series	ESC
Dielectric	Aluminum Electrolytic
Description	LowESR Single Ended Aluminum Electrolytic
Features	Low ESR
RoHS	Yes
Lead	Wire Leads
AEC-Q200	No

### Specifications

Capacitance	100 uF
Capacitance Tolerance	20%
Voltage DC	10 VDC, 13 VDC (Surge)
Temperature Range	-40/+105°C
Rated Temperature	105°C
Life	2000 Hrs
Dissipation Factor	19% 120Hz 20C
ESR	0.42 Ohms (100kHz 20C)
Ripple Current	150 mAmps (100kHz 105C)
Leakage Current	10 uA (2min 20°C)
Impedance Ratio at -25C	3
Impedance Ratio at -40C	6