

SIDE VIEW

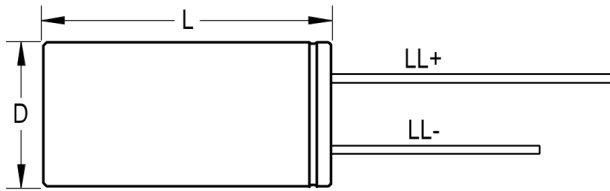

TERMINAL END VIEW

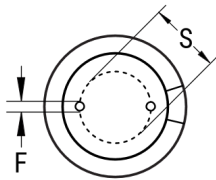

Click [here](#) for the 3D model.

### Dimensions

D	18mm +/-0.5mm
L	36mm +2.0/-0mm
S	7.5mm +/-0.5mm
LL Negative	15mm MIN
LL Positive	20mm MIN
F	0.8mm NOM

### Packaging Specifications

Packaging	Bulk, Bag
-----------	-----------

### General Information

Series	ESH
Dielectric	Aluminum Electrolytic
Description	High CV Single Ended Aluminum Electrolytic
RoHS	Yes
Lead	Wire Leads
AEC-Q200	No

### Specifications

Capacitance	4,700 uF
Capacitance Tolerance	20%
Voltage DC	35 VDC, 44 VDC (Surge)
Temperature Range	-40/+105°C
Rated Temperature	105°C
Life	2000 Hrs
Dissipation Factor	14% 120Hz 25C
Ripple Current	1920 mAmps (120Hz 105C)
Leakage Current	1645 uA (2min 20°C)
Impedance Ratio at -25C	2
Impedance Ratio at -40C	3