

SIDE VIEW

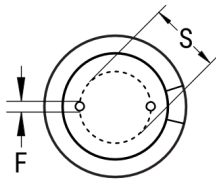

TERMINAL END VIEW



Click [here](#) for the 3D model.

General Information

Series	ESL
Dielectric	Aluminum Electrolytic
Style	Radial
Description	Single Ended Aluminum Electrolytic
RoHS	Yes
Lead	Wire Leads
AEC-Q200	No

Specifications

Capacitance	10 uF
Capacitance Tolerance	20%
Voltage DC	200 VDC, 250 VDC (Surge)
Temperature Range	-40/+105°C
Rated Temperature	105°C
Life	10000 Hrs
Dissipation Factor	15%
ESR	3.65 Ohms (100kHz 20C)
Ripple Current	175 mAmps (100kHz 105C)
Leakage Current	50 uA (2min 20°C)
Impedance Ratio at -40C	6

Dimensions

D	8mm +/-0.5mm
L	12mm +2.0mm
S	3.5mm +/-0.5mm
LL Negative	15mm MIN
LL Positive	20mm MIN
F	0.6mm NOM

Packaging Specifications

Packaging	Bulk, Bag
-----------	-----------