

FLLE2001ASRW2

Aliases (LLE2001ASRW2)

KEMET, FLLE2-SR, EMI/RFI Filters, Noise Suppression, 250 VAC, 1 A, 230x89x93mm

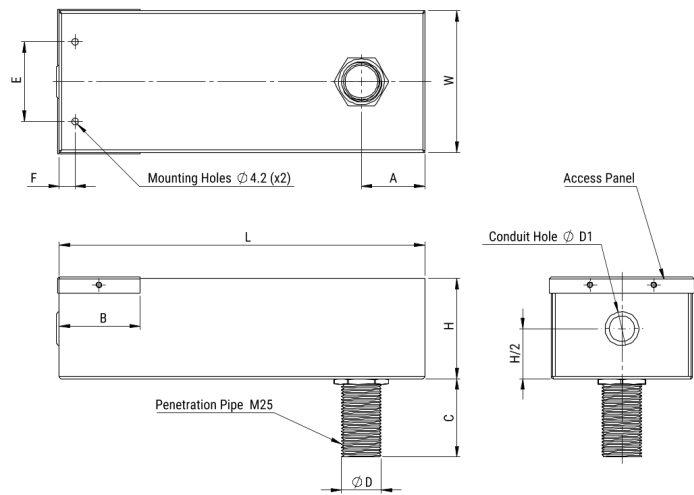

Click [here](#) for the 3D model.

Dimensions	
D	25mm MIN
L	230mm MIN
W	89mm MIN
H	93mm MIN
M (Earth)	Threaded Studs M25
A	40mm
B	51mm

Packaging Specifications	
Packaging	Bulk
Packaging Quantity	1

General Information	
Series	FLLE2-SR
Style	Screen Room Filters
Description	Single Phase Power Line Filters for Shielded Rooms and Secure Areas
Phase	Single-phase
RoHS	Yes
Qualifications	UL 1283
Terminal Type	Threaded Studs M25

Specifications	
Voltage AC	250 VAC
Rated Current	1 A
Rated Temperature	40°C
Temperature Range	-25/+85°C
Climate Category	25/085/21
Leakage Current	2 mA
DC Resistance	800 mOhms
Capacitance	0.023 uF

Statements of suitability for certain applications are based on our knowledge of typical operating conditions for such applications, but are not intended to constitute - and we specifically disclaim - any warranty concerning suitability for a specific customer application or use. This Information is intended for use only by customers who have the requisite experience and capability to determine the correct products for their application. Any technical advice inferred from this Information or otherwise provided by us with reference to the use of our products is given gratis, and we assume no obligation or liability for the advice given or results obtained.