

MPC0750LR68C

Aliases (UPIA0750LR68C0)

Not for New Design

KEMET, MPC, Metal Composite, 20%, 680 nH, 3126

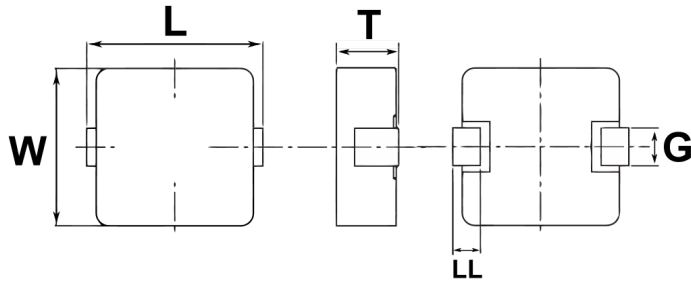

Click [here](#) for the 3D model.

Dimensions

Chip Size	3126
L	8mm MAX
W	6.7mm +/-0.3mm
T	5mm MAX
G	2mm +/-0.3mm

Packaging Specifications

Packaging	T&R, 330mm
Packaging Quantity	1000

General Information

Series	MPC
Style	SMD Molded
Core	Metal Composite
Description	Shielded, Surface Mount Inductor
Features	High Speed, Large Current DC/DC Converter
RoHS	Yes

Specifications

Inductance	680 nH
Inductance Tolerance	20%
Temperature Range	-40/+125°C
Rated Temperature	120°C
Shielded	Yes
Current	16 Amps (Isat, 20% Drop In Inductance), 18 Amps (Irms, 40C Rise By Self Heating)
DC Resistance	2.2 mOhms