

MPCH1060LR45

Aliases (UPIC1060LR4500)
KEMET, MPCH, Metal Composite, 20%, 450 nH, 1060(4739)

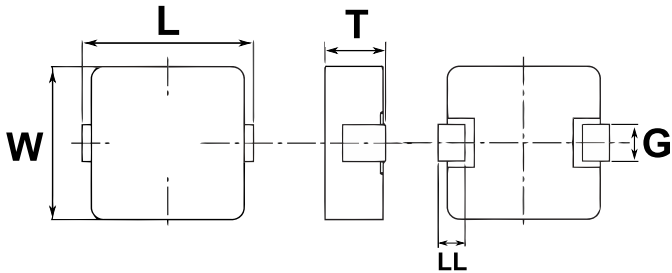

Click [here](#) for the 3D model.

Dimensions	
Chip Size	1060(4739)
L	12mm MAX
W	10mm +/-0.3mm
T	6mm MAX
G	3.5mm +/-0.5mm

Packaging Specifications	
Typical Component Weight	3.7 g
Packaging	T&R, 380mm
Packaging Quantity	500

General Information	
Series	MPCH
Style	SMD Molded
Core	Metal Composite
Description	Shielded, Surface Mount Inductor
Features	Large Current Inductors
RoHS	Yes
Miscellaneous	40 (K) Temperature Rise Max.

Specifications	
Inductance	0.45 uH (0.1 MHz)
Inductance Tolerance	20%
Rated Current	32 A (Irms, 40C Rise By Self Heating)
Saturation Current	32 A (Isat, 20% Drop In Inductance)
Temperature Range	-40/+125°C
Rated Temperature	120°C
Shielded	Yes
DC Resistance	0.76 mOhms
DC Resistance	0.76 mOhms

Statements of suitability for certain applications are based on our knowledge of typical operating conditions for such applications, but are not intended to constitute - and we specifically disclaim - any warranty concerning suitability for a specific customer application or use. This Information is intended for use only by customers who have the requisite experience and capability to determine the correct products for their application. Any technical advice inferred from this Information or otherwise provided by us with reference to the use of our products is given gratis, and we assume no obligation or liability for the advice given or results obtained.