

SCF47C-400-1R8C040JH

Aliases (UALF47C040JH00)

Common Mode Chokes - Power, KEMET, SCF-J/JH, Through-Hole, Common Mode, 4,000 uH

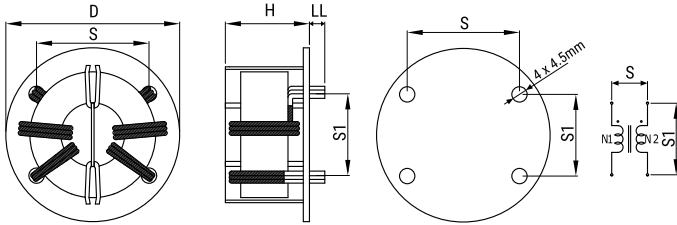

Click [here](#) for the 3D model.

General Information

Series	SCF-J/JH
Style	Through-Hole
Features	High Impedance, Space Saving
RoHS	Yes
Notes	Lead Spacing (S/S1) Are For Reference Only.
Miscellaneous	Temperature Rise Maximum: 55 K.
Core	Nanocrystal

Dimensions

D	70mm MAX
T	39mm
H	38mm MAX
LL	5mm +/-2mm
S	44mm NOM
S1	32mm NOM
Wire Size	1.8mm x 3 Parallel

Packaging Specifications

Packaging	Tray
Packaging Quantity	36
Typical Component Weight	192.7 g

Specifications

Voltage AC	500 VAC
Inductance	4 mH
Rated Current	40 A
Temperature Range	-40/+120°C
DC Resistance	2.1 mOhms

Statements of suitability for certain applications are based on our knowledge of typical operating conditions for such applications, but are not intended to constitute - and we specifically disclaim - any warranty concerning suitability for a specific customer application or use. This Information is intended for use only by customers who have the requisite experience and capability to determine the correct products for their application. Any technical advice inferred from this Information or otherwise provided by us with reference to the use of our products is given gratis, and we assume no obligation or liability for the advice given or results obtained.