

C330C684M5U5TA7303

Aliases (C330C684M5U5TATR)

GoldMax 300 Comm Z5U, Ceramic, 0.68 uF, 20%, 50 VDC, Z5U, GoldMax, Commercial Standard, 5.08mm

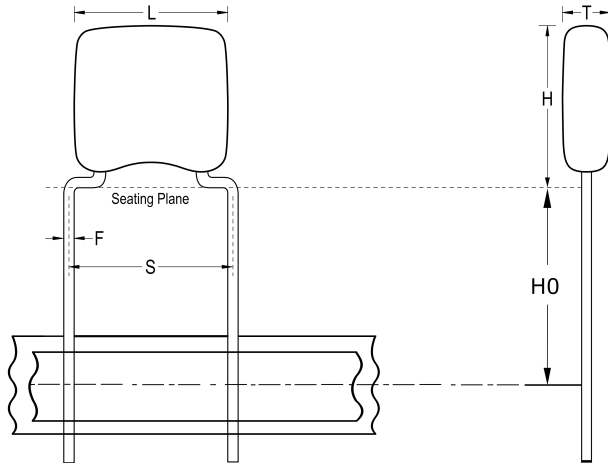

Click [here](#) for the 3D model.

Dimensions

L	7.1mm MAX
H	9.14mm MAX
T	4.07mm MAX
S	5.08mm +/-0.78mm
HO	18mm MIN
F	0.51mm +0.1/-0.025mm

Packaging Specifications

Packaging	T&R, 305mm
Packaging Quantity	1500

General Information

Series	GoldMax 300 Comm Z5U
Style	Radial
Description	GoldMax, Commercial Standard
RoHS	Yes
Termination	Tin
Failure Rate	N/A
AEC-Q200	No
Halogen Free	Yes

Specifications

Capacitance	0.68 uF
Measurement Condition	1 kHz 1.0Vrms
Capacitance Tolerance	20%
Voltage DC	50 VDC
Dielectric Withstanding Voltage	125 VDC
Temperature Range	+10/+85°C
Temperature Coefficient	Z5U
Capacitance Change with Reference to +25°C and 0 VDC Applied (TCC)	'+22%/-56%, 1kHz 1.0Vrms
Dissipation Factor	4% 1kHz 1.0Vrms
Aging Rate	7% Loss/Decade Hour
Insulation Resistance	150 MOhms