

ERK610Z681KYH0

Aliases (C812YH681K440X, ERK610RK3680KYH0)

Obsolete

ERK610 SFTY X1-440 Y2-300, Ceramic, 680 pF, 10%, 440 VAC (X1), 300 VAC (Y2), Y5U, 12.5 mm

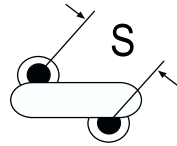
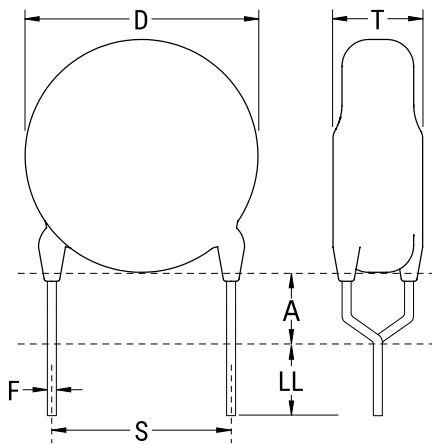

The measurement position of Lead Spacing (S) and Width (V) is critical in straight lead capacitors.

Click [here](#) for the 3D model.

General Information

Series	ERK610 SFTY X1-440 Y2-300
Style	Radial Disc
RoHS	Yes
Termination	Tin
Lead	V-Crimp
Qualifications	UL, CSA, CAN, ENEC, VDE
AEC-Q200	No

Specifications

Capacitance	680 pF
Tolerance	10%
Voltage AC	440 VAC (X1), 300 VAC (Y2)
Temperature Range	-40/+125°C
Temp. Coefficient	Y5U
Dissipation Factor	2.5%
Insulation Resistance	6 GOhms
Safety Class	X1/Y2

Dimensions

D	9mm MAX
T	6mm MAX
S	12.5mm NOM
LL	3mm +2mm
F	0.8mm +/-0.05mm
V	2mm +/-0.5mm

Packaging Specifications

Packaging	Bulk, Bag
-----------	-----------

Statements of suitability for certain applications are based on our knowledge of typical operating conditions for such applications, but are not intended to constitute - and we specifically disclaim - any warranty concerning suitability for a specific customer application or use. This Information is intended for use only by customers who have the requisite experience and capability to determine the correct products for their application. Any technical advice inferred from this Information or otherwise provided by us with reference to the use of our products is given gratis, and we assume no obligation or liability for the advice given or results obtained.