

SIDE VIEW

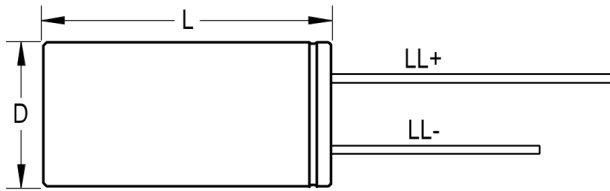

TERMINAL END VIEW

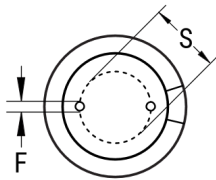

Click [here](#) for the 3D model.

### Dimensions

D	8mm +/-0.5mm
L	11.5mm +2.0mm
S	3.5mm +/-0.5mm
LL Negative	15mm MIN
LL Positive	20mm MIN
F	0.6mm NOM

### Packaging Specifications

Packaging	Bulk, Bag
-----------	-----------

### General Information

Series	ESL
Dielectric	Aluminum Electrolytic
Description	Single Ended Aluminum Electrolytic
RoHS	Yes
Lead	Wire Leads
AEC-Q200	No

### Specifications

Capacitance	330 uF
Capacitance Tolerance	20%
Voltage DC	25 VDC, 32 VDC (Surge)
Temperature Range	-40/+105°C
Rated Temperature	105°C
Life	10000 Hrs
Dissipation Factor	14%
ESR	0.061 Ohms (100kHz 20C)
Ripple Current	965 mAmps (100kHz 105C)
Leakage Current	82.5 uA (2min 20°C)
Impedance Ratio at -40C	6