

FLLE2003APDB

Aliases (LLE2003APDB)

KEMET, FLLE2-P, EMI/RFI Filters, Noise Suppression, 300 VAC, 300 V, 3 A, 51x45x19mm

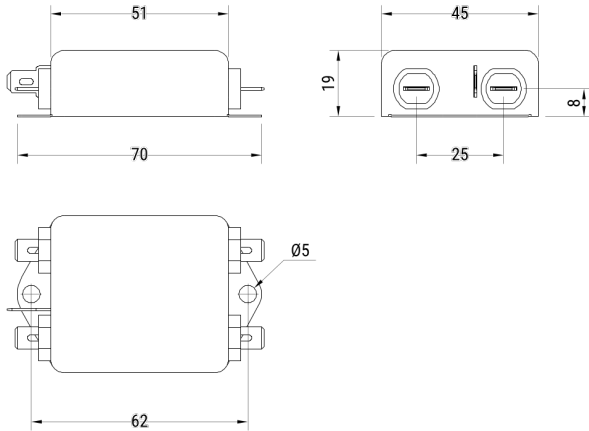

Click [here](#) for the 3D model.

Dimensions

| | |
|---|----------|
| L | 51mm MIN |
| W | 45mm MIN |
| H | 19mm MIN |

Packaging Specifications

| | |
|--------------------------|------|
| Packaging | Bulk |
| Packaging Quantity | 1 |
| Typical Component Weight | 85 g |

General Information

| | |
|----------------|-------------------------------------|
| Series | FLLE2-P |
| Style | Chassis Mount |
| Description | Single Phase, Chassis Mount Filters |
| Features | Single Phase |
| Phase | Single-phase |
| RoHS | Yes |
| Qualifications | IEC/EN 60939, UL, CSA |
| Terminal Type | Faston |

Specifications

| | |
|----------------------------|---------------|
| Voltage AC | 300 VAC |
| Voltage DC | 300 VDC |
| Rated Frequency | 50-60 Hz |
| Rated Current | 3 A |
| Rated Temperature | 40°C |
| Temperature Range | -25/+100°C |
| Climate Category | 25/100/21 |
| Leakage Current | 0.37 mA (MAX) |
| Test Voltage DC (P/N to E) | 2250 VDC |
| Test Voltage DC (P to N) | 1300 VDC |