

# MPC0730LR20C

Aliases (UPIA0730LR20C0)

Not for New Design

KEMET, MPC, Metal Composite, 25%, 200 nH, 3126

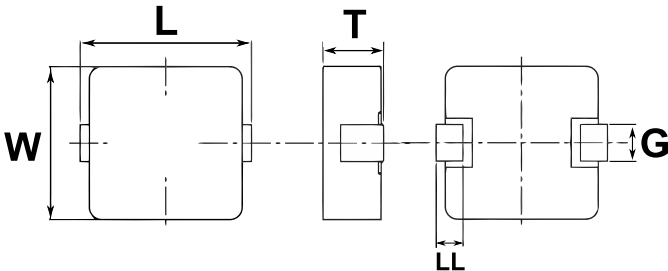

Click [here](#) for the 3D model.

Dimensions	
Chip Size	3126
L	8mm MAX
W	6.7mm +/-0.3mm
T	4mm MAX
G	2mm +/-0.3mm

Packaging Specifications	
Packaging	T&R, 330mm
Packaging Quantity	1000

Specifications	
Inductance	0.2 uH (0.1 MHz)
Inductance Tolerance	25%
Rated Current	23 Amps (Irms, 40C Rise By Self Heating)
Saturation Current	17.5 Amps (Isat, 20% Drop In Inductance)
Temperature Range	-40/+125°C
Rated Temperature	120°C
Shielded	Yes
DC Resistance	1.2 mOhms
DC Resistance	1.2 mOhms

Statements of suitability for certain applications are based on our knowledge of typical operating conditions for such applications, but are not intended to constitute - and we specifically disclaim - any warranty concerning suitability for a specific customer application or use. This Information is intended for use only by customers who have the requisite experience and capability to determine the correct products for their application. Any technical advice inferred from this Information or otherwise provided by us with reference to the use of our products is given gratis, and we assume no obligation or liability for the advice given or results obtained.