

MPC1250LR36C

Aliases (UPIA1250LR36C0)

Not for New Design

KEMET, MPC, Metal Composite, 20%, 360 nH, 5749

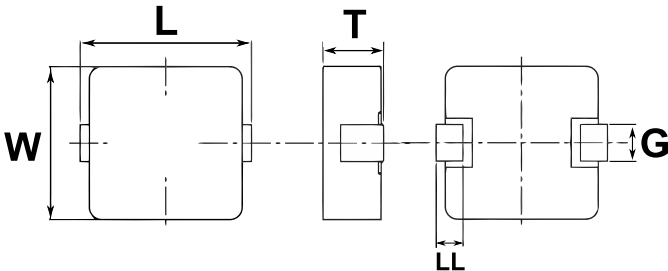

Click [here](#) for the 3D model.

| Dimensions | |
|------------|-----------------|
| Chip Size | 5749 |
| L | 14.5mm MAX |
| W | 12.5mm +/-0.3mm |
| T | 5mm MAX |
| G | 3mm +/-0.5mm |

| Packaging Specifications | |
|--------------------------|------------|
| Packaging | T&R, 380mm |
| Packaging Quantity | 500 |

| Specifications | |
|----------------------|--|
| Inductance | 0.36 uH (0.1 MHz) |
| Inductance Tolerance | 20% |
| Rated Current | 38 Amps (Irms, 40C Rise By Self Heating) |
| Saturation Current | 40 Amps (Isat, 20% Drop In Inductance) |
| Temperature Range | -40/+125°C |
| Rated Temperature | 120°C |
| Shielded | Yes |
| DC Resistance | 0.65 mOhms |
| DC Resistance | 0.65 mOhms |

Statements of suitability for certain applications are based on our knowledge of typical operating conditions for such applications, but are not intended to constitute - and we specifically disclaim - any warranty concerning suitability for a specific customer application or use. This Information is intended for use only by customers who have the requisite experience and capability to determine the correct products for their application. Any technical advice inferred from this Information or otherwise provided by us with reference to the use of our products is given gratis, and we assume no obligation or liability for the advice given or results obtained.