

MPCH1055L1R3

Aliases (UPIC1055L1R300)

KEMET, MPCH, Metal Composite, 20%, 1,300 nH, 1055(4639)

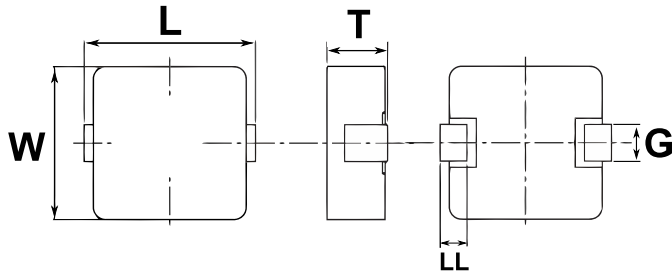

Click [here](#) for the 3D model.

General Information

Series	MPCH
Style	SMD Molded
Core	Metal Composite
Description	Shielded, Surface Mount Inductor
Features	Large Current Inductors
RoHS	Yes
Miscellaneous	40 (K) Temperature Rise Max.

Dimensions

Chip Size	1055(4639)
L	11.7mm MAX
W	10mm +/-0.3mm
T	5.5mm MAX
G	3mm +/-0.5mm

Packaging Specifications

Typical Component Weight	3.4 g
Packaging	T&R, 380mm
Packaging Quantity	500

Specifications

Inductance	1.3 uH (0.1MHz)
Inductance Tolerance	20%
Rated Current	18.5 A (Irms, 40C Rise By Self Heating)
Saturation Current	17 A (Isat, 20% Drop In Inductance)
Temperature Range	-40/+125°C
Rated Temperature	120°C
Shielded	Yes
DC Resistance	2.3 mOhms
DC Resistance	2.3 mOhms

Statements of suitability for certain applications are based on our knowledge of typical operating conditions for such applications, but are not intended to constitute - and we specifically disclaim - any warranty concerning suitability for a specific customer application or use. This Information is intended for use only by customers who have the requisite experience and capability to determine the correct products for their application. Any technical advice inferred from this Information or otherwise provided by us with reference to the use of our products is given gratis, and we assume no obligation or liability for the advice given or results obtained.