

USEQFSEA448180

Aliases (USEQFSEA448180)

Not for New Design

KEMET, QFS, Flame Detection, SMD, Infrared, Small SMD Package, 12C Communication Compatible

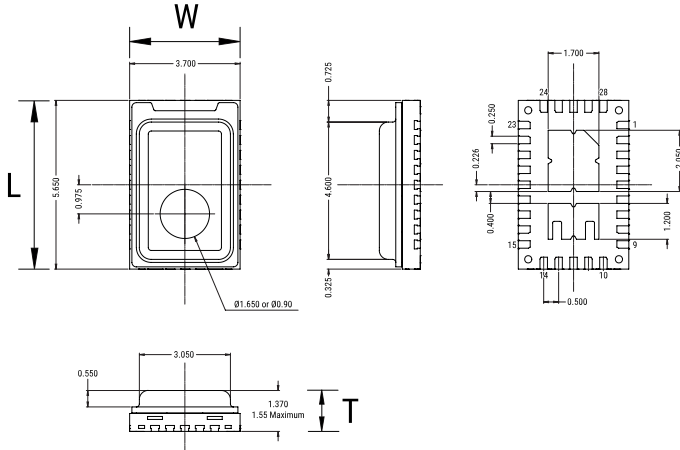

Click [here](#) for the 3D model.

General Information

Series	QFS
Type	Flame Detection
Style	SMD
Description	12C
Features	Small SMD Package, 12C Communication Compatible
RoHS	With Exemptions
REACH	SVHC (PZT - CAS 12626-81-2)
SCIP Number	f8c5f819-a3bd-41c4-887e-bd5dcb8c5edf
Qualifications	REACH
MSL	3

Specifications

Temperature Range	-40/+85°C
Power Supply Voltage	1.75 - 3.6 V
Current	1 - 23 uA (Supply Current, Typical)
Miscellaneous	Flame channel (main detector). Sensor Type: Single.
Field of View	90 degrees

Dimensions

L	5.65mm NOM
W	3.7mm NOM
T	1.55mm MAX

Packaging Specifications

Packaging	T&R, 178mm
Packaging Quantity	800
Typical Component Weight	70 mg

Statements of suitability for certain applications are based on our knowledge of typical operating conditions for such applications, but are not intended to constitute - and we specifically disclaim - any warranty concerning suitability for a specific customer application or use. This Information is intended for use only by customers who have the requisite experience and capability to determine the correct products for their application. Any technical advice inferred from this Information or otherwise provided by us with reference to the use of our products is given gratis, and we assume no obligation or liability for the advice given or results obtained.